

MX SERIES

COOL LOOK, COOL COMFORT

MX-5, MX-6, AND MX-7 PREMIUM EARMUFFS

The MX-5, MX-6 and MX-7 are a cool and comfortable upgrade in earmuffs. The larger cup openings are designed to fit most ear sizes. Exclusive waffled cup foam delivers superior protection in MX-6 and MX-7. The cushion-ribbed headband allows cool comfort all day long and the non-slip wire makes adjustments easy. The MX series are easy to wear and durable, have a sharp, cool look and increase compliance.



SLC₈₀
34dB
Class 5

6130 MX-6



SLC₈₀
32dB
Class 5

6120 MX-5



SLC₈₀
32dB
Class 5

**6140 MX-7
CAP MOUNTED**

WARNING:

1. Use this laboratory derived attenuation data for comparison purposes only. The amount of protection afforded in field use often is significantly lower depending upon how the protectors are fitted and worn.
2. Failure to follow all instructions could result in hearing loss or injury.
3. Failure to obtain a proper fit will reduce effectiveness of hearing protectors and could result in hearing loss or injury.
4. Over protection can be dangerous. The wearer must be able to hear warning signals.
5. Wearers with hearing loss should exercise extreme caution.
6. It is the employer's responsibility to ensure that the type of hearing protector and its SLC₉₀ protection is appropriate for the user in their particular workplace.
7. Failure to follow these warnings could result in serious injury or death.
8. Moldex earmuffs must only be used as part of a hearing conservation program that complies with applicable local safety and health regulations.

Ordering Information

Model	Part #	Display Qty.	Case Qty.
MX-5 Earmuff	6120	1 Pair/Box	10 Boxes
MX-6 Earmuff	6130	1 Pair/Box	10 Boxes
MX-7 Cap Mounted Earmuff (ADP130 Adapter*)	6140	1 Pair/Box	10 Boxes
MX-7 Cap Mounted Earmuff (ADP225 Adapter*)	6142	1 Pair/Box	10 Boxes
ADP330 Adapter Only* (Earmuff not included)	6143	1 Pair/Bag	20 Bags
MX-5 Hygiene Kit	6125	1/Pair/Bag	20 Bags
MX-6/MX-7 Hygiene Kit	6135	1/Pair/Bag	20 Bags

*See Adapter Chart

ATTENUATION DATA FOR AUSTRALIA / NEW ZEALAND

Tested According to AS/NZS 1270 by Michael & Associates.
 Note: For full details of methods of selecting a hearing protector, see AS/NZS 1269.3
 Hearing protector Class 5 tested to AS/NZS 1270. When selected, used and maintained as specified in AS/NZS 1269.3, this protector may be used in noise up to 110dB(A) assuming an 85dB(A) criterion.
 A lower criterion may require a higher protector class.

MX-5 EARMUFFS

Frequency (Hz)	125	250	500	1000	2000	4000	8000	
Mean Attenuation (dB)	19.0	22.1	31.4	37.2	36.8	35.1	36.6	SLC₉₀ 32dB, Class 5
Standard Deviation (dB)	3.0	2.8	3.3	3.5	3.0	3.4	3.9	
Mean Minus Standard Deviation (dB)	16.0	19.3	28.1	33.7	33.8	31.7	32.7	

MX-6 EARMUFFS

Frequency (Hz)	125	250	500	1000	2000	4000	8000	
Mean Attenuation (dB)	21.5	24.4	32.7	38.3	39.2	44.0	39.4	SLC₉₀ 34dB, Class 5
Standard Deviation (dB)	3.4	2.7	3.2	3.7	3.0	3.8	4.6	
Mean Minus Standard Deviation (dB)	18.1	21.7	29.5	34.6	36.2	40.2	34.8	

MX-7 CAP MOUNTED EARMUFFS

Frequency (Hz)	125	250	500	1000	2000	4000	8000	
Mean Attenuation (dB)	22.9	23.4	31.1	36.7	36.7	40.6	36.8	SLC₉₀ 32dB, Class 5
Standard Deviation (dB)	4.2	3.5	4.2	4.8	2.4	4.1	4.9	
Mean Minus Standard Deviation (dB)	18.7	19.9	26.9	31.9	34.3	36.5	31.9	

MX-5/MX-6 SERIES INSTRUCTIONS FOR USE:

Earmuffs must be fitted and worn correctly to provide effective protection. Earmuffs and their cushions may deteriorate with use and should be examined for cracking or other deformations and replaced as necessary. Routinely wash with mild soap and water. The foam liner should be allowed to air dry before reinserting into the earmuffs.

- 1) With headband over-the-head, pull the cups outward and position over your ears so that they fully enclose the ear and seal tightly against the head.
- 2) Adjust the height of the cups until you have a tight and comfortable fit. For best results, remove all hair from under the cushions.
- 3) Maintenance: Replace cushions and foam inserts at least twice a year for hygiene and safety. For MX-5 order Part No. 6125 and for MX-6 order Part No. 6135. For MX-6 only: Place the glossy side of the foam against the cup.

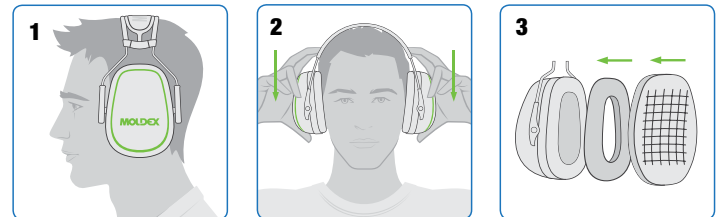

MX-7 SERIES INSTRUCTIONS FOR USE:

Cap Mounted Earmuffs must be fitted and worn correctly to provide effective protection. Earmuffs and their cushions may deteriorate with use and should be examined for cracking or other deformations and replaced as necessary. Routinely wash with mild soap and water. The foam liner should be allowed to air dry before reinserting into the earmuffs.

- 1) Position top of cup below helmet. Helmet must rest level on head with brim straight forward and be fitted correctly, per manufacturer's instructions.
- 2) Press arm to snap against side of head. An audible click will be heard.
- 3) Adjust position of each cup on wire so both ears are completely and comfortably sealed inside cup cushions. Cup must be sealed around the ear, without any interference from any part of the helmet. If any part of the helmet, including the suspension, contacts the cup or cushion, then readjust. If cup cannot be adjusted to avoid contact with helmet, then hearing protection will be reduced and muffs must not be worn.
- 4) For maximum hearing protection, there must be no interference between the cup cushion sealing surface and wearer's head. Pull hair back outside the cushion sealing area and remove anything that interferes with the cushion seal. Any interference with sealing area (e.g. eyewear, respirator straps, etc.) will significantly reduce hearing protection. To minimize this, use the thinnest temples and straps.
- 5) Do not bend or reshape the wires.
- 6) To remove, pull cup out until an audible click is heard.
- 7) Maintenance: Replace cushions and foam inserts at least twice a year for hygiene and safety. MX-7 order Part No. 6135. Place the glossy side of the foam against the cup.

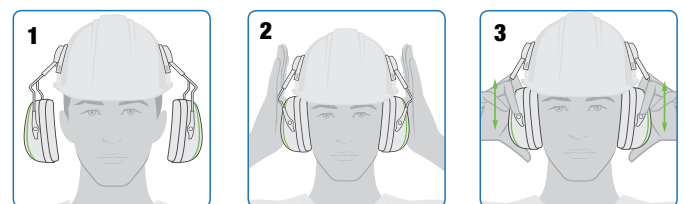

Adapter Chart

Adapter	Compatible Hardhats
ADP130	MSA V-Gard, Honeywell HH1, Prosafe 610
ADP225	Unisafe TA560/570, Protector Alsafte HC43 / HC600V, ProChoice HH9, Prosafe 630
ADP330	Prosafe 410, Prosafe 620, Prosafe 630



MOLDEX-METRIC, INC.
 Moldex-Metric, Inc.
 10111 West Jefferson Blvd., Culver City, CA 90232
 TEL: +1 (800) 421-0668 or +1 (310) 837-6500
 FAX: +1 (310) 837-9563
 E-mail: sales@moldex.com
 www.moldex.com

AUSTRALIA
 P.O. Box 4086
 Carlingford, North NSW 2118
 TEL: +61 (02) 9838 7588
 FAX: +61 (02) 9838 7544
 E-mail: moldexaustralia@moldex.com
 www.moldex.com

NEW ZEALAND
 3 Spence Road
 Henderson, Auckland, NZ
 TEL: +64 (9) 837 8247
 FAX: +64 (9) 837 8248
 E-mail: moldexnz@moldex.com
 www.moldex.com

